

Rear End Components



est. 1946



GT2 S/S Coil-Over Shock Mount Spacers: These investment cast spacers come in three different depths; 1 1/4", 1 1/2" and 1 3/4" and are designed to solve the most complicated coil over shock ride height problems. They are available in a polished or plain finish.

(A) #001-63101 Spacers 1 1/4" polished: \$49.00 pr.
 (B) #001-63102 Spacers 1 1/2" polished: \$49.00 pr.
 (C) #001-63103 Spacers 1 3/4" polished: \$49.00 pr.
 (D) #001-63104 Spacers 1 1/4" plain: \$39.00 pr.
 (E) #001-63105 Spacers 1 1/2" plain: \$39.00 pr.
 (F) #001-63106 Spacers 1 3/4" plain: \$39.00 pr.

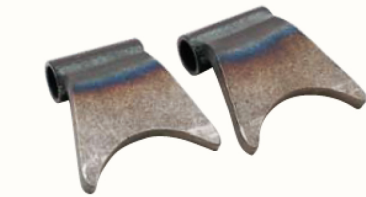

Model 'A' Rear Spring Hangers: These weld-on brackets mount to the top of the rear end housing and are designed for a 2 1/4" wide spring (see page 38, #001-63100).
 #001-50112 'A' spring hanger: \$66.00 pr



GT2 Lower Rear End Shock Brackets: These universal brackets mount either standard tube shocks or, with the addition of our coil over spacers, are easily converted to accept a pair of coil over suspension shocks. They have three vertical 5/8" dia. ride height adjustment holes on 1" centers and (2) 5/8" dia. lower control arm mounting holes and fit a 3" dia. housing.
 #001-63801 Shock brackets: \$54.95 pr.



Lower Rear End Coil-Over Shock Mounts: These shock mounts offer a variety of mounting holes and weld-on to the rear end housing.

(A) #001-63204 C/O mount w/o hardware: \$99.54 pr.
 (B) #001-63203 C/O mount w/hardware: \$118.74 pr.

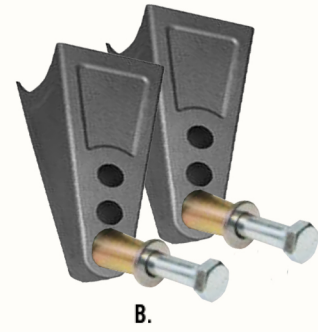

Rear Buggy Spring Hangers: These hangers are designed to be slipped over 3" dia. rear axle housing tubes then welded in place
 #001-63201 Spring hanger: \$95.94 pr.



S/S Rear Spring Clamps: These stamped polished S/S clamps are designed for 2 1/4" rear springs and come with polished S/S fasteners.
 #001-60612 Rear S/S clamp: \$34.80 pr.

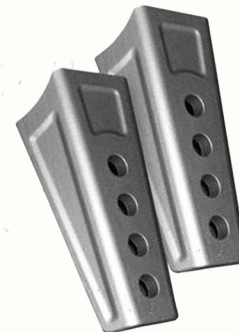

Lower Rear End Shock Mounts: These stamped and formed lower rear mounts are designed for regular tube type shock absorbers. They offer a variety of mounting holes and weld-on to the rear end housing.

(A) #001-63202 Rear mount w/o hardware: \$49.95 pr.
 (B) #001-63205 Rear mount w/hardware: \$77.94 pr.

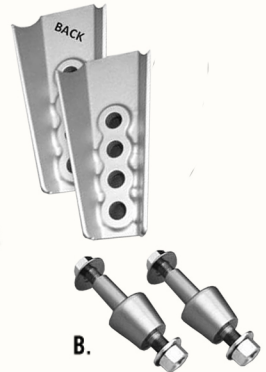

Model 'A' Rear Spring U-Bolt Kit: This kit is a direct replacement for '28 to '31 Model 'A' Ford stock rear crossmembers. It has a fabricated steel base plate, 9/16"-18 threaded mild steel U-bolts and Nylok nuts.
 #001-62175 Model 'A' rear U-bolt kit: \$59.94 pr.